

sc.1:10

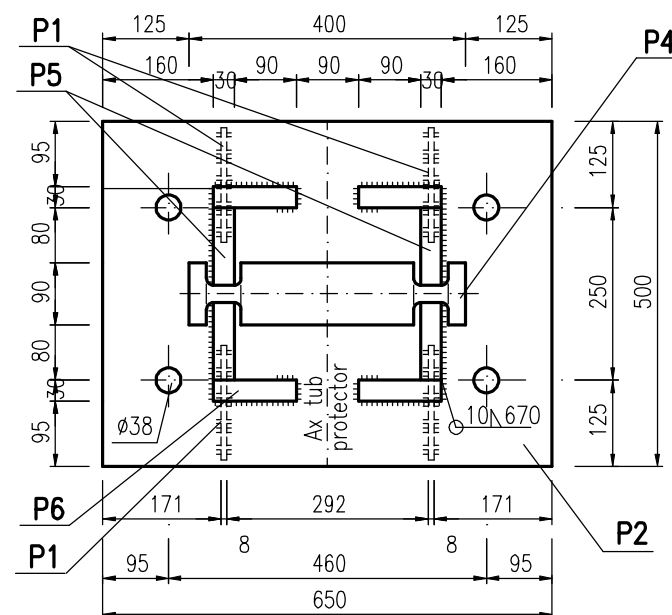

Technical drawing showing the connection between a metal pile (Pila metalica) and a tubular pile (Tub protector).

The drawing includes the following dimensions and labels:

- Dimensions:**
 - 120 (Distance between centerlines of the piles)
 - 182 (Distance between centerlines of the connection bolts)
 - 8 (Thickness of the tubular pile wall)
 - 15 (Thickness of the metal plate)
 - 90 (Height of the console)
 - 15 (Height of the metal plate)
 - 140 (Total height of the connection)
- Labels:**
 - P1, P2, P3, P4, P5, P6, P7, P8, P9, P10, P11, P12, P13, P14 (Parts of the connection)
 - Pila metalica (Metal pile)
 - Consola (Console)
 - Tub protector (Tubular pile)

sc.1:10

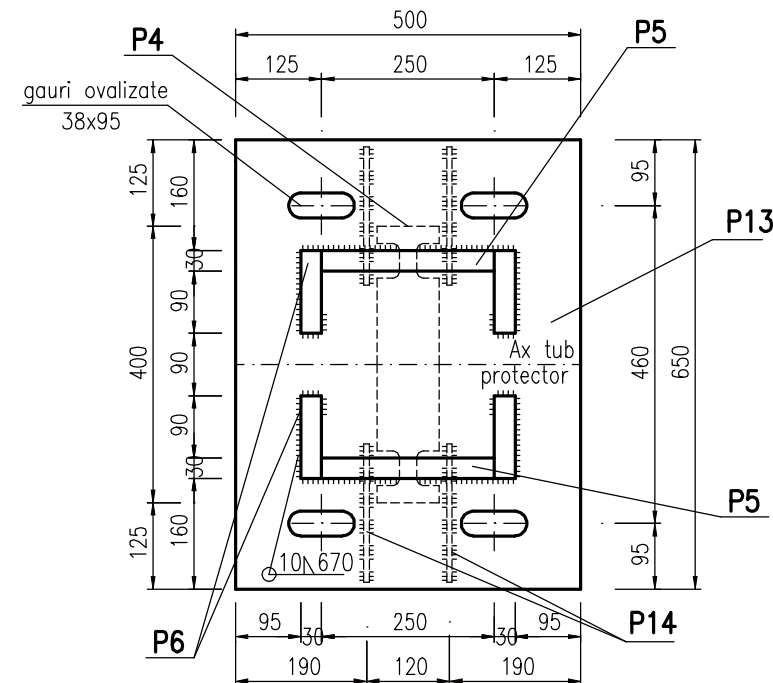

- Produse laminate la cald din oteluri de constructie nealiat conform SR EN 10025+A1 din OL37(S235).
- Clasele de calitate ale otelului vor fi cf.SR EN 1993-1-10:2006/NA:2008.
- Imbinari cu suruburi de inalta rezistenta grupele 8.8 sau 10.9.

297x420 A3